

PROFLOW™ CLEANING PARTS AND CARE INSTRUCTIONS

Washing Cleaning

Warm, Cold & Soapy Water



OR

Soda Water

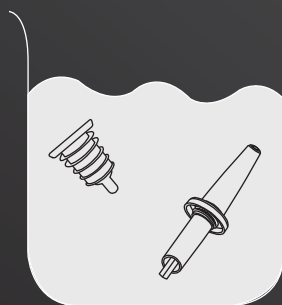

Refreshing corks

After long periods of use

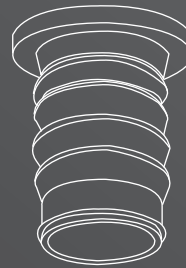

The fins on the cork may form to the shape of the bottle neck



Hot water

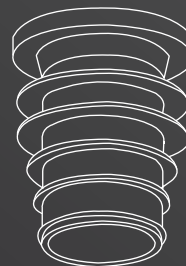

The fins will return to original state



WARNING: DO NOT PLACE ANY PART IN A GLASSWASHER, DISHWASHER OR BOILING WATER